

**Carrera**<sup>®</sup>  
**DIGITAL 124**

**Carrera**<sup>®</sup>  
**DIGITAL 132**

## 20030361 PIT STOP ADAPTER UNIT

- |                      |   |               |  |
|----------------------|---|---------------|--|
| <b>D</b>             | Montage- und Betriebsanleitung              | <b>SK</b>     | Návod na montáž a pre prevádzku        |
| <b>GB</b> <b>USA</b> | Assembly and instructions                   | <b>CZ</b>     | Návod na montáž a pro provoz           |
| <b>F</b>             | Instructions de montage et d'utilisation    | <b>BG</b>     | Ръководство за монтаж и експлоатация   |
| <b>E</b>             | Instrucciones de uso y montaje              | <b>GR</b>     | Μοντάζ και Οδηγία χρήσης               |
| <b>P</b>             | Instruções de montagem e modo de utilização | <b>RO</b>     | Instrucțiuni de montaj și de utilizare |
| <b>I</b>             | Istruzioni per il montaggio e l'uso         | <b>DK</b>     | Monterings- og driftsvejledning        |
| <b>NL</b>            | Montage- en gebruiksaanwijzing              | <b>RC</b>     | 安裝和使用說明                                |
| <b>S</b>             | Monterings- och bruksanvisning              | <b>J</b>      | 取扱説明書取扱説明書の内容は予                        |
| <b>FIN</b>           | Asennus- ja käyttöohjeet                    | <b>ROK</b>    | 조립과 작동 방법                              |
| <b>N</b>             | Montajse- og bruksanvisning                 | <b>Arabic</b> | إرشادات التركيب و الأستخدام            |
| <b>H</b>             | Ősszeszerelési és használati útmutató       | <b>TR</b>     | Montaj ve işletme kılavuzu             |
| <b>PL</b>            | Instrukcja obsługi i montażu                | <b>RUS</b>    | Инструкция по монтажу и эксплуатации   |

**Aufbauvorschlag · Assembly proposal · Suggestion de montage · Propuesta de montaje  
Sugestão de montagem · Suggestimento per il montaggio · Opbouwvoorstel · Monteringsförslag  
Kokoamishdotus · Oppbygningsforslag · Felépítési javaslat · Propozycja montażu  
Návrh postavenia · Návrh na uspořádání · Предложение за монтаж · Πρόταση σύνδεσης  
Propunere de asamblare · Oppbygningsforslag · 建造指南 · 組立方法 · 조립방법  
إرشادات البناء والتركيب · Kurma önerisi · Предложение по монтажу**

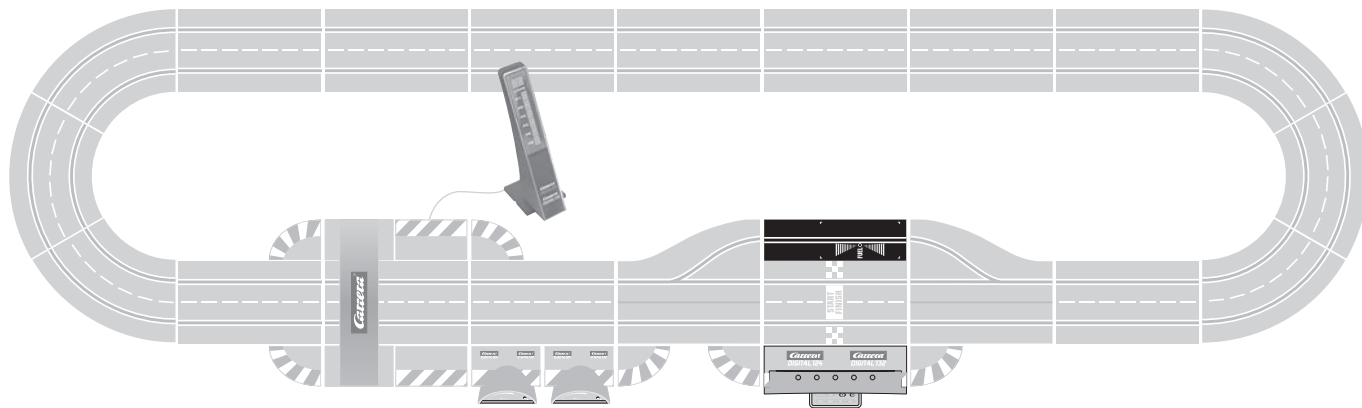

## Table of contents

Safety instructions .....	7
Description .....	7
Contents of package .....	7
Assembly instructions .....	8
Pit Lane for Pace Car function .....	8
Maintenance and care .....	8
Important information .....	8
Troubleshooting / Driving tips .....	9
Technical specifications .....	9

## Welcome

Welcome to the Team Carrera!

The operating instructions contain important information regarding assembly and operation of your Carrera DIGITAL 124/132 Pit Stop Adapter Unit. Please read them carefully and keep them in a safe place afterwards.

If you have any queries, please do not hesitate to contact our distributor or visit our website: [carrera-toys.com](http://carrera-toys.com)

Please check the contents for completeness and possible transport damage. The packaging contains important information and should also be retained.

We hope you will derive a lot of pleasure from your new Carrera DIGITAL 124/132 Pit Stop Adapter Unit.

## Safety instructions

• **WARNING!** Not suitable for children under 36 months. Danger of suffocation due to small parts which may be swallowed.  
Warning: Risk of pinching caused by function.

### • WARNING!

This toy contains magnets or magnetic components. Magnets attracting each other or a metallic object inside the human body may cause serious or fatal injuries. Seek medical attention immediately if magnets are swallowed or inhaled.

• The transformer is not a toy! Do not short-circuit the transformer's connections! Note to parents: Regularly inspect the transformer for damage to the cable, plug or housing! Only operate the toy with recommended transformers! The transformer may no longer be used if it is damaged! Only operate the racetrack with a transformer! If play is interrupted for longer periods, it is recommended to separate the transformer from the power supply. Do not open transformer or speed controller housings!

### Important note to parents:

Transformers and power supply units are not suitable to be used as toys. The use of such products needs to be constantly supervised by the parents.

- Regularly check the track and cars for damage to cables, plugs and housings! Replace defective parts.
- The car racetrack is not suitable for outdoor operation or operation in wet locations! Keep away from liquids.
- Do not place any metal parts onto the track to avoid short-circuits. Do not place the track in the immediate vicinity of delicate objects, as these could be damaged by cars hurled from the track.
- Disconnect the plug before cleaning or servicing the racetrack! Only use a damp cloth for cleaning, no solvents or chemicals. When it is not in use, store the track in a dry and dust-protected location, preferably in the original cardboard box.
- Do not operate race track at face- or eye-level – risk of injury due to cars being catapulted off the track.

### Note:

The vehicle may only be operated again in a completely assembled condition. Assembly may only be carried out by an adult.

## Description

In the Pit Lane, the cars' refuelling as well as the lap counting are carried out. Lap counting in the Pit Lane can be deactivated. Displaying of the tank fuel capacity is only possible in combination with the Driver Display 20030353. To upgrade an existing Pit Stop Lane 20030346 the Pit Stop Adapter Unit 20030361 is required.

**For further information on settings and fuelling function please refer to the manual of the Control Unit (20030352).**

**The full range of its functions is only guaranteed when used in combination with the Control Unit (20030352). For precise information on its operation please refer to the Control Unit's manual (20030352).**

## Contents of package

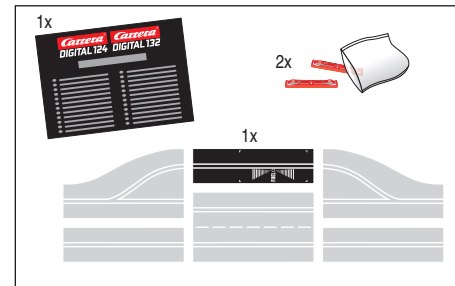

- 1 Pit Stop Adapter Unit
- 2 Track section bolts  
Instructions

## Assembly instructions

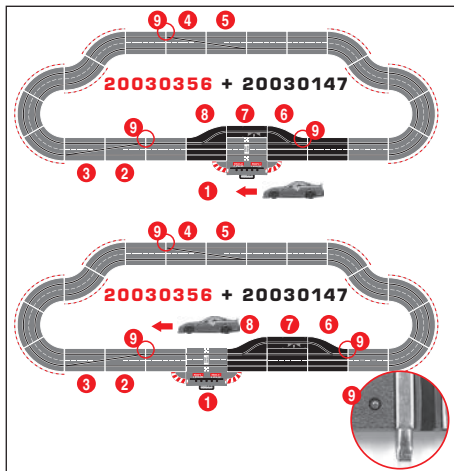

- 1 Connecting track + Black Box
- 2 Lane change section left input
- 3 Lane change section left output
- 4 Lane change section right input
- 5 Lane change section right output
- 6 Pit Stop Lane entry switch
- 7 Pit Stop Adapter Unit
- 8 Pit Stop Lane exit switch
- 9 Infrared sensor:

The infrared sensor MUST be located on the switch that functions as the entry rail (dark diode).

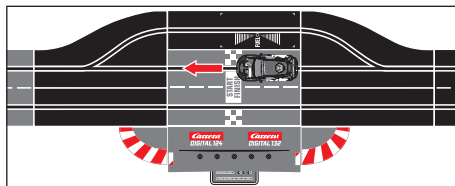

The lettering "FUEL" on the Pit Stop Adapter Unit must be readable in driving direction.

## Pit Lane for Pace Car function

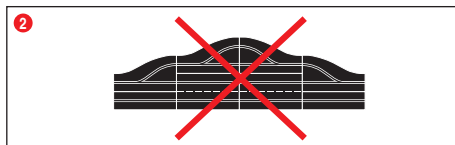
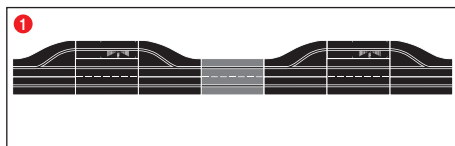

In order to be able to use the Pace Car- and Pit Stop function at the same time, two Pit Lanes are required (see fig. 1).

It is not possible to extend the Pit Lane in the Pit Lane (see fig. 2) as the second Pit Lane switch cannot be triggered!

A standard straight should always be positioned between the entry- and exit switch.

## Maintenance and care

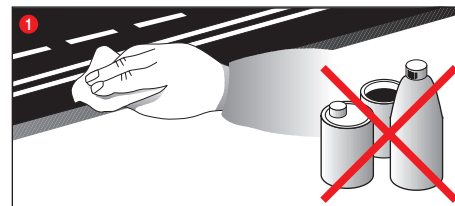

To ensure a proper operation of the motor-racing circuit, all race-track components should be regularly cleaned. Pull the plug prior to cleaning.

**1 Racetrack:** Keep the track surface and track slots clean with a dry cloth. Do not use any solvents or chemicals for cleaning. When it is not in use, store the racetrack in a clean and dust-protected location, preferably in the original cardboard box.

## Important information



EVOLUTION

Carrera DIGITAL 124/132





Please note that Evolution (analog system) and Carrera DIGITAL 124/132 (digital system) involve two separate and completely independent systems. We hereby expressly indicate that both systems must be kept separate when setting up the track, i.e. no connecting rail from Evolution may be used together with the connecting rail and Black Box of the Carrera DIGITAL 124/132, even if only one of the two connecting rails (Evolution connecting rail or Carrera DIGITAL 124/132 connecting rail and Black Box) is attached to the current supply. Furthermore, no other Carrera DIGITAL 124/132 components (switches, electronic lap counter, pit stop) may be built into an Evolution course, i.e. via analog operation. Non-compliance with the above information may result in damage or destruction of the respective Carrera DIGITAL 124/132 components. In this case no warranty may be claimed.

## Troubleshooting Driving tips

### Troubleshooting:

In case of any malfunctions, please check the following:

- Has the connection to the power supply been established correctly?
- Have transformer and speed controllers been connected correctly?
- Are the track connections faultless?
- Are the racetrack and track slots clean and free of any foreign objects?
- Are the sliding contacts in order and do they make contact with the track slot?
- Are the cars correctly coded to the according speed controller?
- The track's current feed will be switched off automatically for 5 seconds, if there is an electrical short circuit: This will be notified by audible and visual signals.
- Are the cars placed on the track in running direction? In case of non-functioning push the running direction switch which is on the car's bottom.

### Note:

During operation small car parts as spoilers or mirrors may get off or brake due to being original detailed parts of the car model. To avoid this it is possible to remove them before operation.

### Driving technique:

- You can drive fast along the straight track but you should brake before the curve and then accelerate again when coming out of the curve.
- Do not fasten or block the vehicles when the motor is running: overheating or damage to the motor could result otherwise. **Note:** When using track systems which are not manufactured by Carrera the existing guide keel has to be replaced by the special guide keel (#20085309). While using the Carrera crossing (#20020587) or high banked curve 1/30° (#20020574) slight driving noise might occur which is due to the full-scale genuineness and does not affect flawless operation.

All Carrera spare parts are available in the webshop: [carrera-toys.com](http://carrera-toys.com)

Delivery exclusively to Germany, Austria, Netherlands, Belgium and Luxembourg.

## Technical specifications

**GB** Output voltage: Toy transformer



18 V  $\text{---}$  54 VA (Carrera DIGITAL 124)  
14,8 V  $\text{---}$  51,8 VA (Carrera DIGITAL 132)

### Electricity modes:

- 1.) Operating mode = cars are operated via speed controllers
- 2.) Idle mode = speed controllers not activated, no game
- 3.) Stand-by mode = after approx. 20 minutes idle mode the connecting section switches to stand-by mode. LED flashes at long intervals. **CURRENT CONSUMPTION < 1 watt / 1w**  
To reactivate the controller, switch it off for 2 or 3 seconds, then switch it on again. The racetrack is then once again in standby mode.
- 4.) Off-state = power supply unit disconnected from mains supply



This device is marked by "selective sort through" symbol related to sort through domestic, electric and electronic, waste. This means the product must be treated by a specialized "sorting/collecting" system in accordance with European directive 2012/19/CE, to reduce the impact upon environment. For more precise information, please contact your local administration. Electrical product which are not going through special collecting, are potentially dangerous for environment and human health, because of dangerous substance.

**USA** Output voltage: Toy transformer



18 V  $\text{---}$  54 VA (Carrera DIGITAL 124)  
14,8 V  $\text{---}$  51,8 VA (Carrera DIGITAL 132)

### Electricity modes:

- 1.) Operating mode = cars are operated via speed controllers
- 2.) Idle mode = speed controllers not activated, no game
- 3.) Stand-by mode = after approx. 20 minutes idle mode the connecting section switches to stand-by mode. LED flashes at long intervals. **CURRENT CONSUMPTION < 1 watt / 1w**  
To reactivate the controller, switch it off for 2 or 3 seconds, then switch it on again. The racetrack is then once again in standby mode.
- 4.) Off-state = power supply unit disconnected from mains supply



Conforms to the safety requirements of ASTM F963.





Stadlbauer Marketing + Vertrieb GmbH · Rennbahn Allee 1 · 5412 Puch / Salzburg · Austria

[carrera-toys.com](http://carrera-toys.com)